

**LOAD AND RESISTANCE FACTOR DESIGN DATA**

Class AA Concrete  $f'_c = 4,000$  p.s.i.  
 Reinforcing Steel (Grade 60)  $f_y = 60,000$  p.s.i.  
 Loading: HL93 and Oklahoma Overload Truck  
 Design: AASHTO LRFD Bridge Design Specification, 7th Edition with Interims through 2016.

**INDEX OF SHEETS**

SHEET NO.	TITLE
17	Summary of Pay Quantities and Notes (Bridge)
145	General Plan and Elevation
146	4 - 5'x4' RCB Culvert Details (Sheet 1 of 5)
147	4 - 5'x4' RCB Culvert Details (Sheet 2 of 5)
148	4 - 5'x4' RCB Culvert Details (Sheet 3 of 5)
149	4 - 5'x4' RCB Culvert Details (Sheet 4 of 5)
150	4 - 5'x4' RCB Culvert Details (Sheet 5 of 5)

**SUMMARY OF QUANTITIES**

ITEM	UNIT	TOTAL
UNCLASSIFIED EXCAVATION	C.Y.	243.00
STRUCTURAL EXCAVATION UNCLASSIFIED	C.Y.	147.00
CLASS AA CONCRETE	C.Y.	316.70
REINFORCING STEEL	LB.	49,569.00
TYPE I PLAIN RIPRAP	C.Y.	64.00
REMOVAL OF BRIDGE ITEMS	LSUM	1.00

**HYDRAULIC DATA**

(Ultimate Condition)  
 Drainage Area = 0.06 sq. mi.

Q0T > Q500 = 286 cfs	Q25 = 161 cfs
V500 = 8.38 fps	V25 = 7.02 fps
Q500 HW = 1130.40	Q25 HW = 1129.08
Q2 = 71 cfs	Q50 = 184 cfs
V2 = 5.34 fps	V50 = 7.33 fps
Q2 HW = 1128.25	Q50 HW = 1129.27
Q5 = 107 cfs	Q100 = 208 cfs
V5 = 6.17 fps	V100 = 7.62 fps
Q5 HW = 1128.59	Q100 HW = 1129.47
Q10 = 129 cfs	
V10 = 6.56 fps	
Q10 HW = 1128.80	

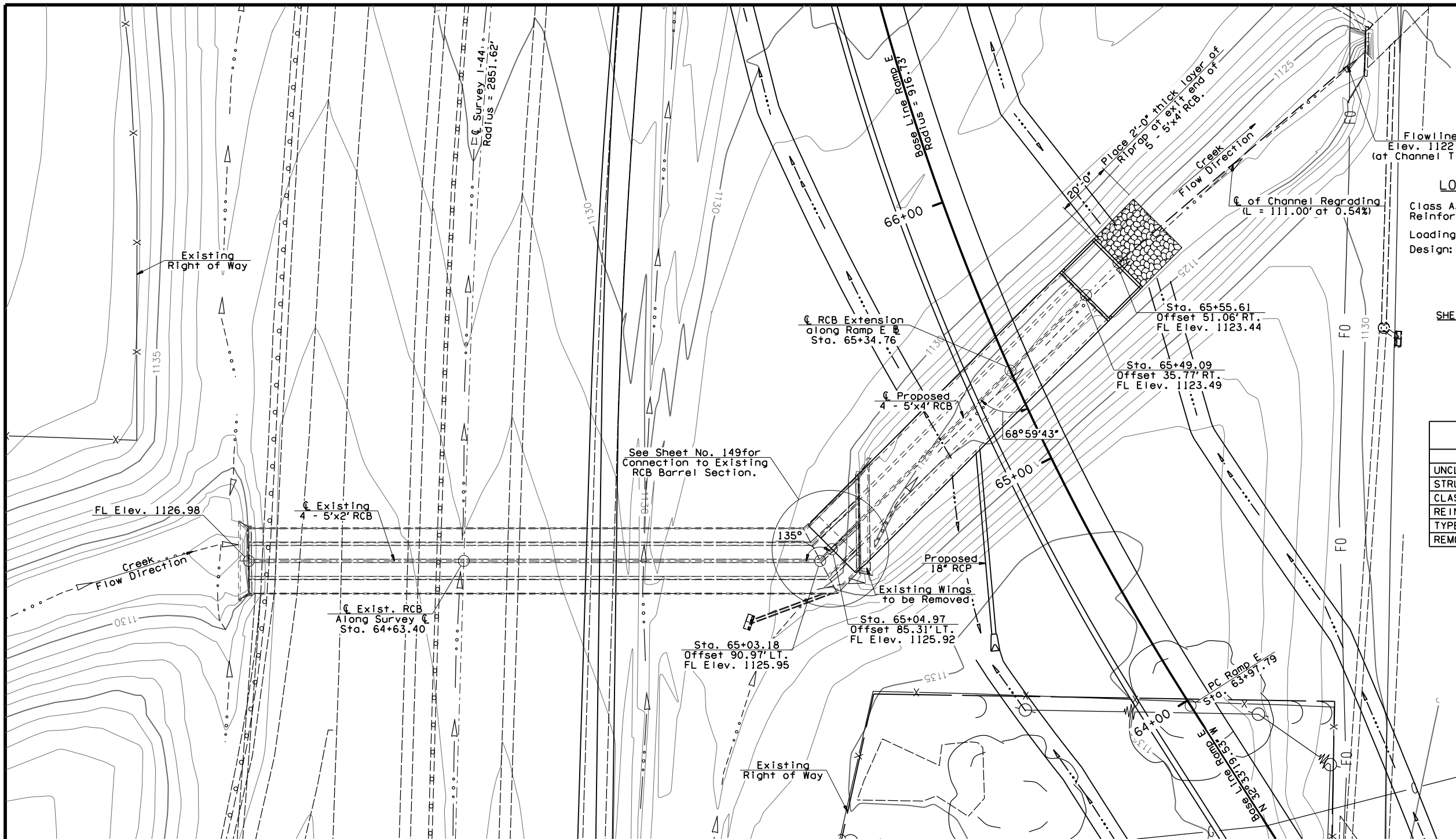

**PLAN**

**NOTE:**  
 Stationing and offsets shown are measured from @ Ramp E.

① See Plan & Profile sheets for additional Channel Regrading Details. Quantities for Channel Regrading to be included in Roadway Quantities.

**BENCHMARK NO. 43**  
 Chiseled Square on S.E. corner of South Headwall  
 OFFSET: 27' RIGHT STATION: 396+43 ELEVATION: 1134.97

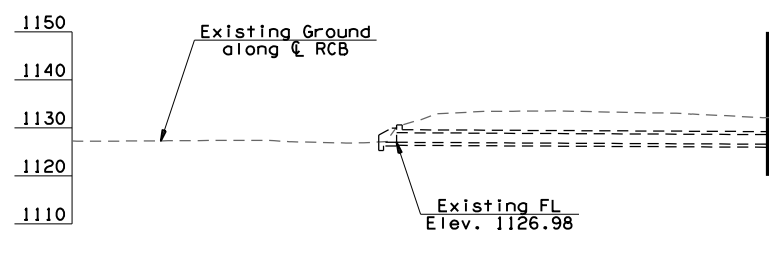

**ELEVATION**  
 (Along CL RCB)

**BENCHMARK NO. 44**  
 2" Aluminum Cap at End of Overpass I-44  
 ELEVATION: 1144.60

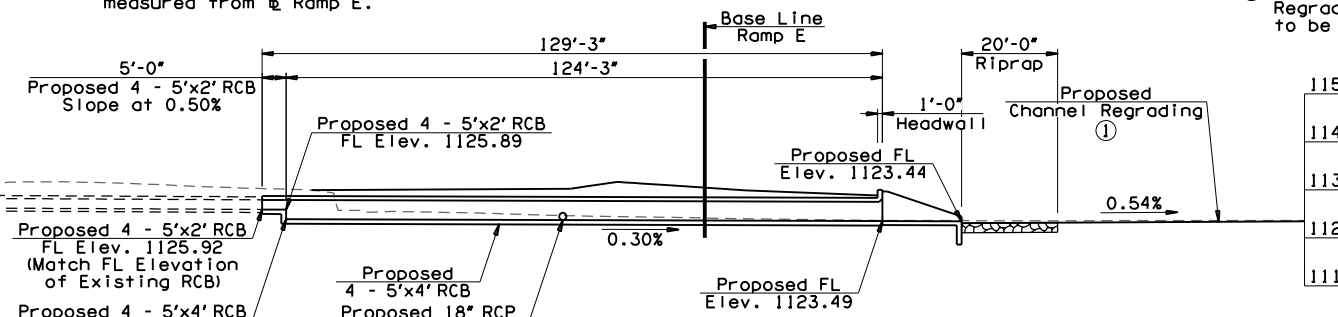

**BENCHMARK NO. 45**  
 Top of Stem. H.A.R.N. Mon. \*TWO\* & ODOT Mon. No. C-16-1081  
 = BM #3 SWO 3748(1) I-44  
 OFFSET: 192' LEFT STATION: 70+72 ELEVATION: 1140.31

I-44 OVER CREEK BRIDGE "B"  
 COMANCHE COUNTY  
 GENERAL PLAN AND ELEVATION  
 (CONSTRUCT 4 - 5'x2'x5' & 4 - 5'x4'x124' RC BOX EXTENSION WITH 4' CURTAIN WALL AT EAST END OF EXISTING 4 - 5'x2' RC BOX WITH 4'-0" CURTAINWALL)  
 DESIGN BRT 07/12  
 DETAIL BRT 07/12  
 CHECK MJY 07/12  
**GARVER**

**STATE OF OKLAHOMA** DEPARTMENT OF TRANSPORTATION  
 JOB PIECE NO. 27050(04) SHEET NO. 145